

## A. 包裝內容

■ 主機 X 1, 配件包 X 1(塑膠壁虎 X 3, 固定螺絲 X 3, 1N4004 X 1, 排線: 2pin X 1, 4pin X 1, 5pin X 1, 6pin X 1, 8pin X 1), CD X 1, 保固卡 X 1, 安裝指南 X 1

## B. 安裝

### ■ 準備工作

1. 將牆面擦拭乾淨
2. 貼上定位防水橡膠片
3. 依照指示孔位鑽孔
4. 打入塑膠壁虎。

### ■ 使用機體下方明線孔安裝

1. 使用起子打開主機後蓋。
2. 用內附螺絲將後蓋固定在安裝位置。
3. 參考步驟 C 完成線路安裝。
4. 將纜線由下方出線孔穿出。

### ■ 使用機體後方暗線孔安裝

1. 使用起子打開主機後蓋。
2. 將纜線由後蓋出線孔穿出。
3. 用內附螺絲將後蓋固定在安裝位置。
4. 參考步驟 C 完成線路安裝。
5. 組合機體, 固定機體下方螺絲。

### ■ 外觀尺寸: 80 X 120 X 25 (mm)

### ■ 建議採用: 遮蔽電纜線, 線性直流電源, 網路線

### ■ 注意事項

- 除電源線外, 其他電線勿與電源接觸。
- 採用不符合規格之變壓器可能會造成系統不穩定或對硬體造成損傷。

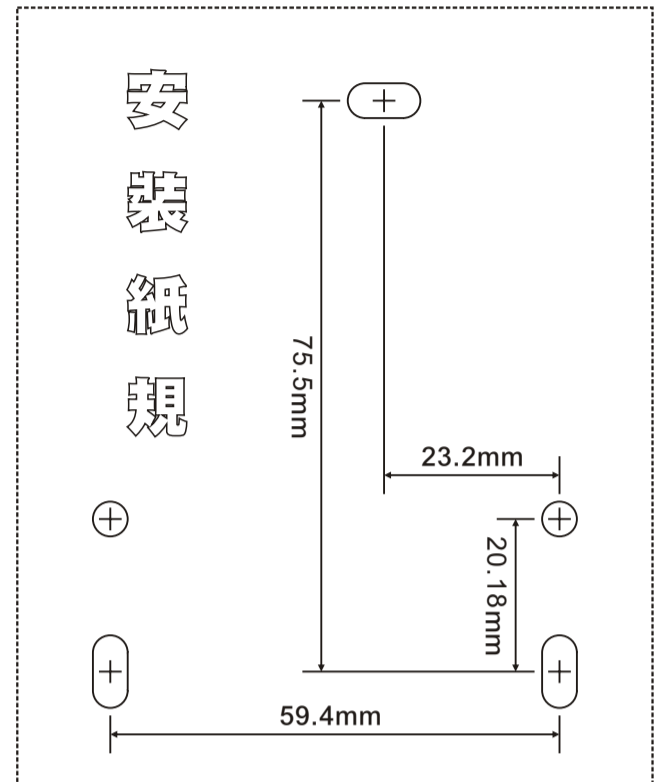
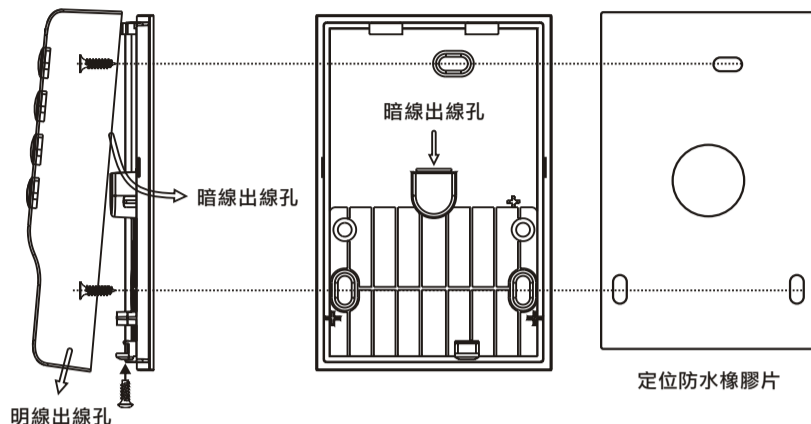

### ■ 規格

- 電壓範圍: 9-24V DC
- 最大電流: 600 mA
- 微根通訊最遠距離: 80M
- RS-485 通訊最遠距離: 1000M

## C. 系統配線圖

### ■ 排線說明

排線	網路線
J1	RJ-45
1 TX+	黑色 橙白
2 TX-	紅色 橙色
3 RX+	綠色 綠白
4 RX-	黃色 綠色

排線	網路線
J9	485
1 485-	灰色
2 485+	棕色
3 FGND	橙色 GND
4 OD0	紅白 微根輸出
5 OD1	黑白
6 GND	橙色 GND
7 OUT	黃白 TTL(5V) output
8 IN	藍白 火警輸入

排線	網路線
J3	微根輸入
1 WID0	紫白
2 WID1	綠白
3 GND	橙色 GND
4 BUZZ	藍黑 控制 WG 讀頭之 LED 與蜂鳴器
5 LED	黃黑

排線	網路線
J4	磁簧開關
1 SENR	藍色
2 GND	橙色 GND
3 DOOR	紫色 開門按鈕
4 NC	黃色 門鎖繼電器
5 COM	綠色
6 NO	白色

排線	網路線
J8	電源
1 VIN-	黑色
2 VIN+	紅色

### ※ 門禁繼電器接點說明

#### • 通電開門

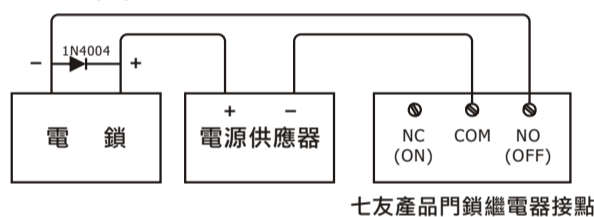

#### • 斷電開門

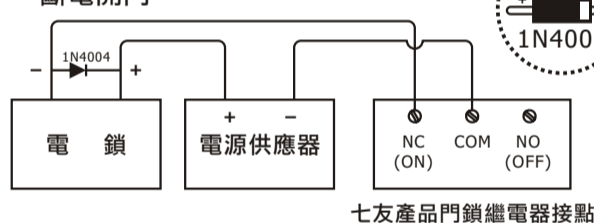

### ● BF-50 的 RJ-45 與感應讀頭接線說明

微根通訊最遠距離: 80M

排線	網路線	說明
1 橘白	D0	
2 橘	D1	
3 綠白	讀頭 LED 控制接點	
4 藍	讀頭蜂鳴器控制接點	
5 藍白	讀頭讀卡控制 (與 GND 短路才能讀卡)	
6 綠	偵測讀頭	
7 棕白	POWER-	DC 9-24V (輸出) 和 BF-50 輸入電壓相同
8 棕	POWER+	

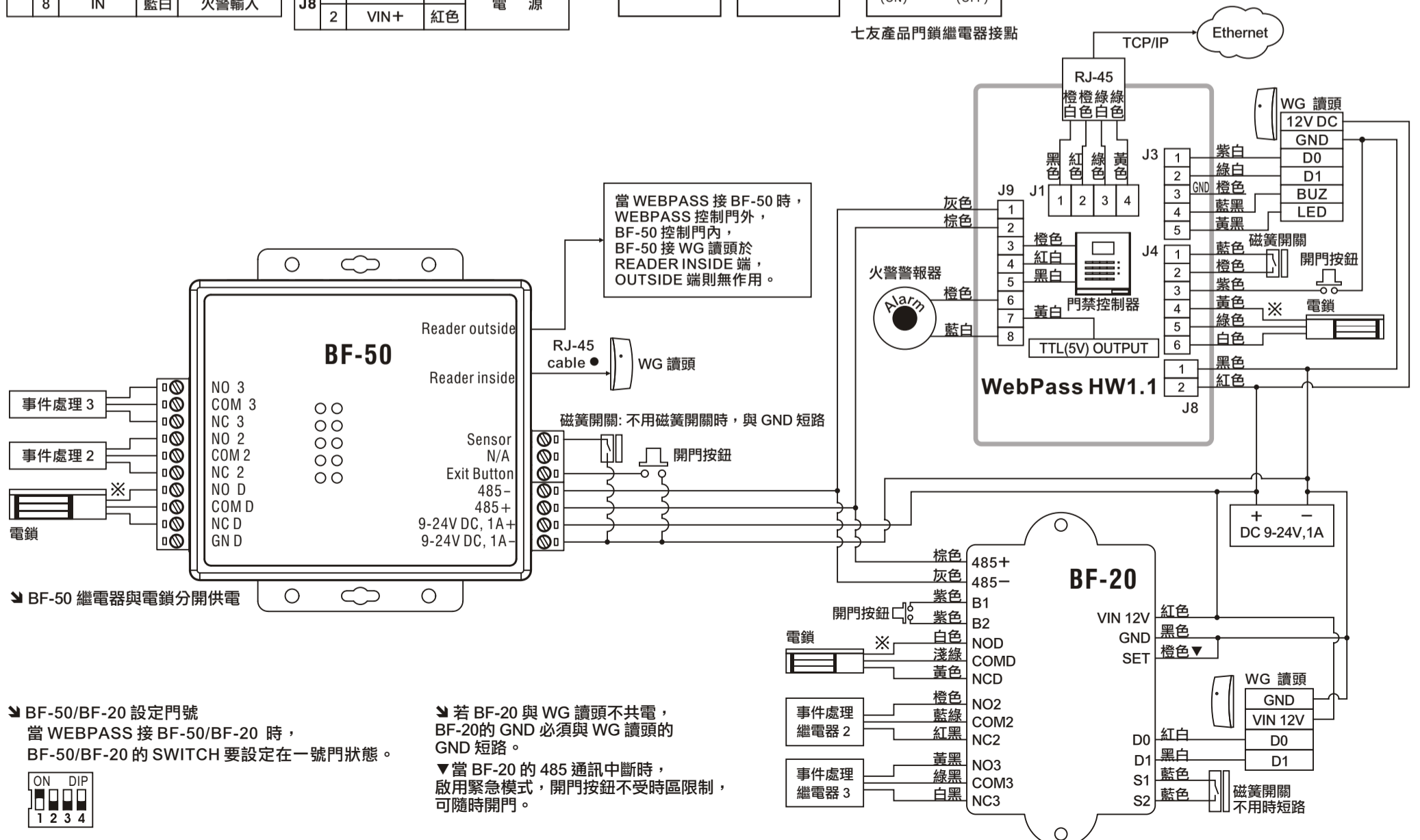

### ▼ BF-50 繼電器與電鎖分開供電

### ▼ BF-50/BF-20 設定門號

當 WEBPASS 接 BF-50/BF-20 時, BF-50/BF-20 的 SWITCH 要設定在一號門狀態。



▼ 若 BF-20 與 WG 讀頭不共電, BF-20 的 GND 必須與 WG 讀頭的 GND 短路。

▼ 當 BF-20 的 485 通訊中斷時, 啟用緊急模式, 開門按鈕不受時區限制, 可隨時開門。

## A. Package content

- Controller X 1, Accessory kit X 1 (Plastic screw X 3, Fastening screw X 3, 1N4004 X 1, Cable: 2pin X 1, 4pin X 1, 5pin X 2, 8pin X 1), CD X 1, Warranty card X 1, Installation Guide X 1

## B. Installation

### Preparation

- Wipe dust and wet from the wall.
- Fasten the waterproof plastic plate on the wall.
- Drill the holes indicating on the plastic plate.
- Fasten the plate with plastic screws to each holes.

### Using the line hole under side

- Use the screw driver to open the back cover of host.
- Install the back cover by using the screws which attached inside.
- Please refer to process C to finish the installation.
- Pass the cable through the line hole under side.
- Combine the machine body, and then fix the screw under the machine.

### Using the line hole at back cover

- Use the screw driver to open the back cover of host.
- Pass the cable through the line hole at the back cover.
- Install the back cover by using the screws which attached inside.
- Please refer to process C to finish the installation.
- Combine the machine body, and then fix the screw under the machine.

### Physical Dimension: 80 X 120 X 25 (mm)

### RECOMMENDED

- Cable with shielded, Linear DC power supply, Network cable.

### SPECIFICATIONS

- Voltage range: 9-24V DC
- Current max. Average: 600 mA
- Max distance for wiegand is 80M
- Max distance for RS-485 is 1000M

### Notice

- Do not connect other cable to the power unit except red & black power cable.
- Do not apply any unverified power supply to the unit or the hardware system may be damaged or may cause system an unstable condition.

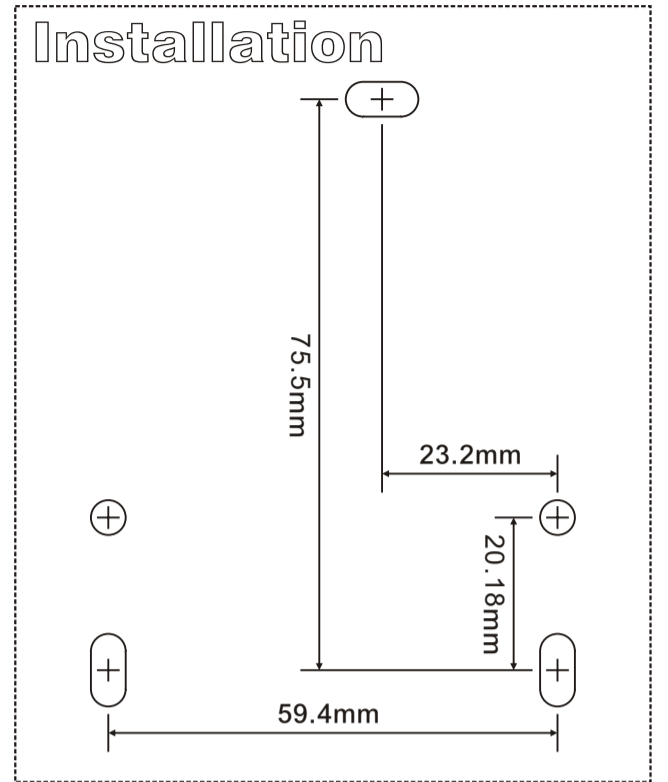
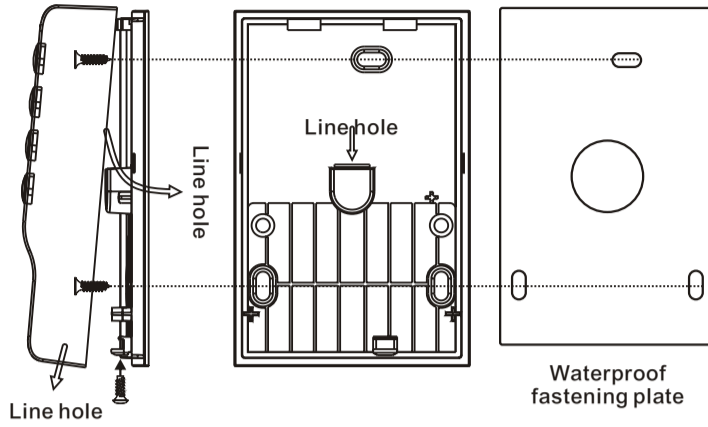

## C. System Connection

### Connector table

J1	Cable		LAN Cable		RJ-45
	Pin	Color	Pin	Color	
1	TX+	BLACK	ORANGE	WHITE	
2	TX-	RED	ORANGE		
3	RX+	GREEN	GREEN	WHITE	
4	RX-	YELLOW	GREEN		

J9	Pin	Color	Function	
	1	485-	GREY	485
	2	485+	BROWN	
	3	FGND	ORANGE	GND
	4	OD0	RED WHITE	WIEGAND OUT
	5	OD1	BLACK WHITE	
	6	GND	ORANGE	GND
	7	OUT	YELLOW WHITE	TTL(5V) output
8	IN	BLUE WHITE	FIRE ALARM INPUT	

J3	Pin	Color	Function	
	1	WID0	VIOLET WHITE	WIEGAND IN
	2	WID1	GREEN WHITE	
	3	GND	ORANGE	GND
	4	BUZZ	BLUE BLACK	Used to control LED and Buzzer of WG Reader
5	LED	YELLOW BLACK		

J4	Pin	Color	Function	
	1	SENR	BLUE	SENSOR
	2	GND	ORANGE	GND
	3	DOOR	VIOLET	EXIT BUTTON
	4	NC	YELLOW	DOOR RELAY
	5	COM	GREEN	
6	NO	WHITE		

J8	Pin	Color	Function
	1	VIN-	BLACK
2	VIN+	RED	

### Door Relay Connect.

#### Fail Secure Lock

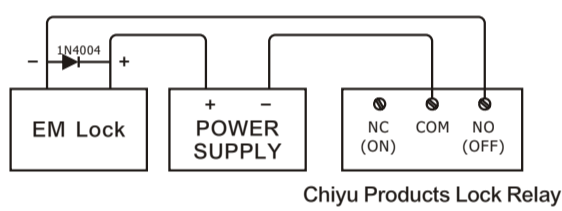

#### Fail Safe Lock

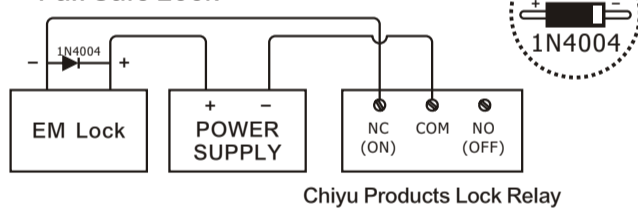

### BF-50 RJ-45 Cable Color Read for Reader Connection

Max distance for wiegand is 80M

Pin	Color	Function	Notes
1	ORANGE WHITE	D0	
2	ORANGE	D1	
3	GREEN WHITE	Output, Controlled the LED of Reader	
4	BLUE	Output, Controlled the Buzzer of Reader	
5	BLUE WHITE	Reader sensing control ( Must short GND)	
6	GREEN	To detect Reader	
7	BROWN WHITE	POWER-	9-24V DC power output, same as BF-50 power input.
8	BROWN	POWER+	

BF-50/BF-20 Door number setting switch should be at door 1st. When WEBPASS is connected with BF-50/BF-20.



If BF-20 doesn't use common battery with WG reader, GND of BF-20 must be short-circuited with GND of WG reader.

Emergency mode enable:

Exit button 'can't be limited by time zone setting when RS-485 disconnect, door still can be opened.

When WEBPASS is connected with BF-50, BF-50 will be used for reader inside. Socket reader outside will be in no function.

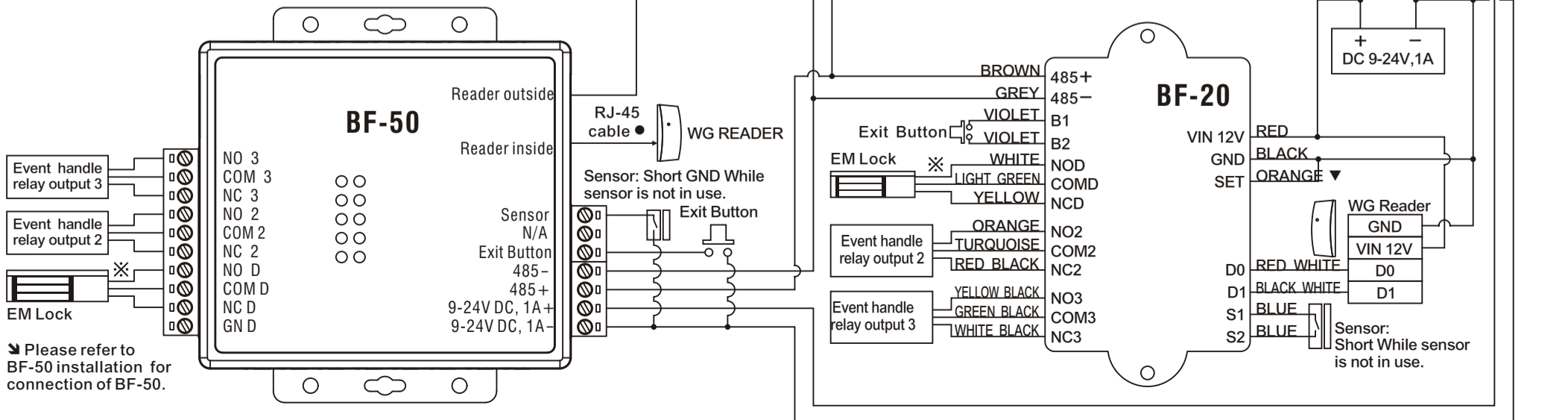

Please refer to BF-50 installation for connection of BF-50.